

LOGEMENTS

202	502	702
203	503	703
205	505	705
209	509	709
211	510	710
	511	711
302	505	712
303	509	714
305	510	716
309	511	
310	512	803
311	514	805
312	516	809
314		810
316	603	811
	605	812
403	609	813
405	610	814
409	611	816
410	612	
411	614	
412	616	
414		
416		



LOGEMENT TYPE 1

SUPERFICIE: 55.4m²

- | | |
|-------------------|-------------------------------|
| 1. CUISINE | 3.1x3.0m 3.7m ² |
| 2. SALLE À MANGER | 3.7x1.8m 6.0m ² |
| 3. SALON | 3.7x2.7m 9.6m ² |
| 4. SALLE DE BAIN | 1.8x2.7m 5.0m ² |
| 5. RANGEMENT | 2.5x1.5m 3.7m ² |
| 6. CHAMBRE | 3.4x4.0m 13.7m ² |



LOGEMENTS

201
301
401
501
601
701
801

LOGEMENT TYPE 1A

SUPERFICIE: 56.3m²



- 1. CUISINE 3.1x3.0m | 3.7m²
- 2. SALLE À MANGER 3.7x1.8m | 6.0m²
- 3. SALON 3.7x2.7m | 9.6m²
- 4. SALLE DE BAIN 1.8x2.6m | 4.7m²
- 5. RANGEMENT 1.9x1.7m | 3.2m²
- 6. CHAMBRE 3.9x2.9m | 11.2m²



A

LOGEMENTS

313
413
513
613
713



LOGEMENT TYPE 2

SUPERFICIE: 70.6m²

- 1. CUISINE 3.1x3.0m | 3.7m²
- 2. SALLE À MANGER 3.7x1.8m | 6.0m²
- 3. SALON 3.7x2.7m | 9.6m²
- 4. SALLE DE BAIN 1.8x2.6m | 4.7m²
- 5. RANGEMENT 1.9x1.7m | 3.2m²
- 6. CHAMBRE 1 3.9x2.9m | 11.2m²
- 7. CHAMBRE 2 3.7x2.9m | 10.7m²



LOGEMENTS

208

9.5m

11.7m



LOGEMENT TYPE 3

SUPERFICIE: 81.6m²

- | | |
|-------------------|-------------------------------|
| 1. CUISINE | 3.2x2.5m 8.0m ² |
| 2. SALLE À MANGER | 2.4x2.5m 6.0m ² |
| 3. SALON | 2.9x4.0m 11.6m ² |
| 4. SALLE DE BAIN | 1.8x3.2m 5.8m ² |
| 5. RANGEMENT | 1.4x3.2m 4.5m ² |
| 6. CHAMBRE 1 | 3.8x3.1m 11.8m ² |
| 7. CHAMBRE 2 | 3.4x2.7m 9.2m ² |

0 1 2 5m

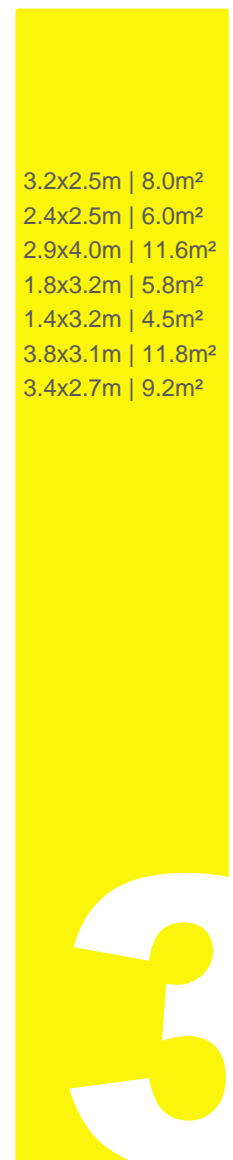

LOGEMENTS

307
407
507
607
707
807

LOGEMENT TYPE 4

SUPERFICIE: 84.4m²



- 1. CUISINE 2.5x5.2m | 13.0m²
- 2. SALLE À MANGER 2.1x3.9m | 8.2m²
- 3. SALON 3.2x3.9m | 12.5m²
- 4. SALLE DE BAIN 2.0x2.5m | 5.0m²
- 5. RANGEMENT 1.5x3.3m | 5.0m²
- 6. CHAMBRE 1 3.3x3.8m | 12.5m²
- 7. CHAMBRE 2 3.1x3.2m | 9.9m²

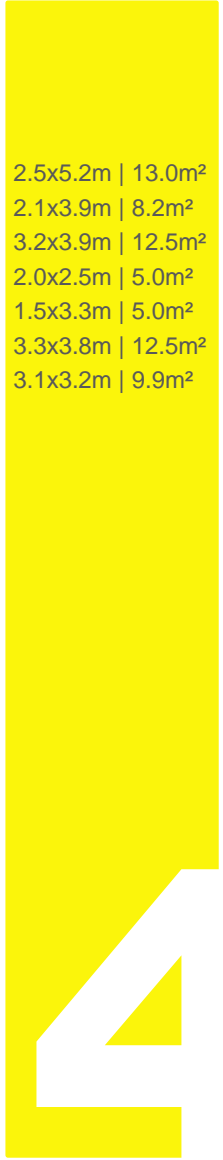

LOGEMENT TYPE 4A

SUPERFICIE: 83.6m²

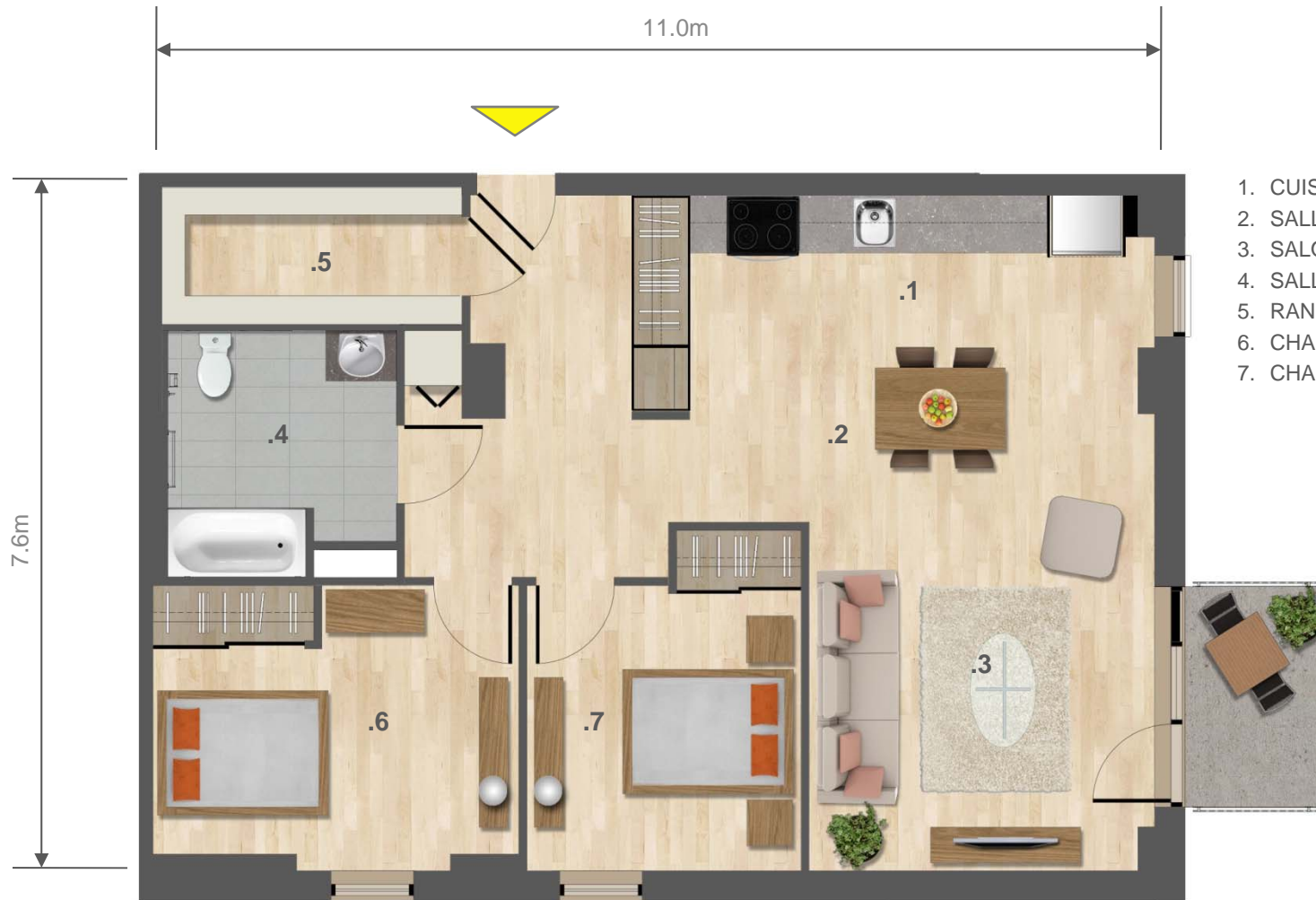

- | | |
|-------------------|-------------------------------|
| 1. CUISINE | 1.7x5.1m 8.7m ² |
| 2. SALLE À MANGER | 2.0x3.8m 7.6m ² |
| 3. SALON | 3.8x3.9m 14.8m ² |
| 4. SALLE DE BAIN | 1.8x3.2m 5.8m ² |
| 5. RANGEMENT | 1.5x3.3m 5.0m ² |
| 6. CHAMBRE 1 | 2.5x4.0m 10m ² |
| 7. CHAMBRE 2 | 3.0x3.0m 9.0m ² |

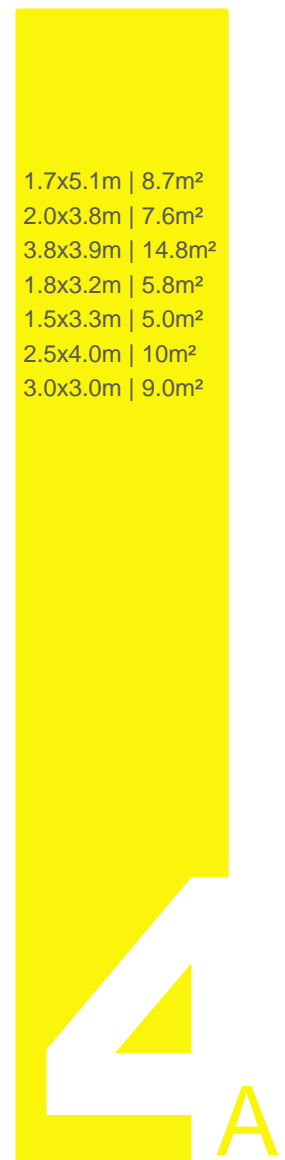

LOGEMENTS

308
408
508
608
708
808



LOGEMENT TYPE 5

SUPERFICIE: 61.8m²

- | | |
|-------------------|-------------------------------|
| 1. CUISINE | 2.4x2.5m 6.0m ² |
| 2. SALLE À MANGER | 2.0x3.6m 7.2m ² |
| 3. SALON | 3.6x3.2m 11.5m ² |
| 4. SALLE DE BAIN | 2.6x2.5m 6.5m ² |
| 5. RANGEMENT | 1.8x2.5m 4.5m ² |
| 6. CHAMBRE 1 | 3.9x4.2m 16.4m ² |

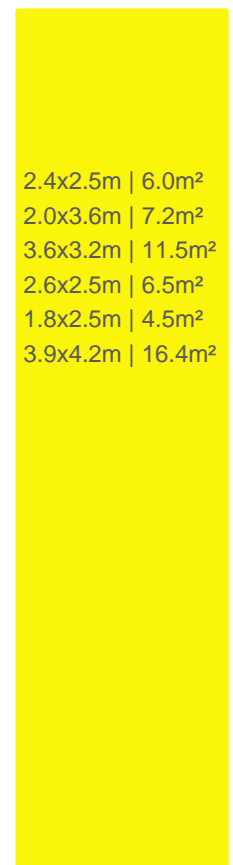

LOGEMENTS

402
602
802



LOGEMENT TYPE 6

SUPERFICIE: 71.5m²

- | | |
|-------------------|-------------------------------|
| 1. CUISINE | 2.4x2.4m 5.8m ² |
| 2. SALLE À MANGER | 1.9x3.4m 6.5m ² |
| 3. SALON | 3.1x3.4m 10.5m ² |
| 4. SALLE DE BAIN | 1.9x2.8m 5.3m ² |
| 5. RANGEMENT | 1.4x2.7m 3.8m ² |
| 6. CHAMBRE 1 | 3.6x3.9m 14.0m ² |
| 7. CHAMBRE 2 | 2.8x4.6m 12.9m ² |

